

WIRE DIAGRAM

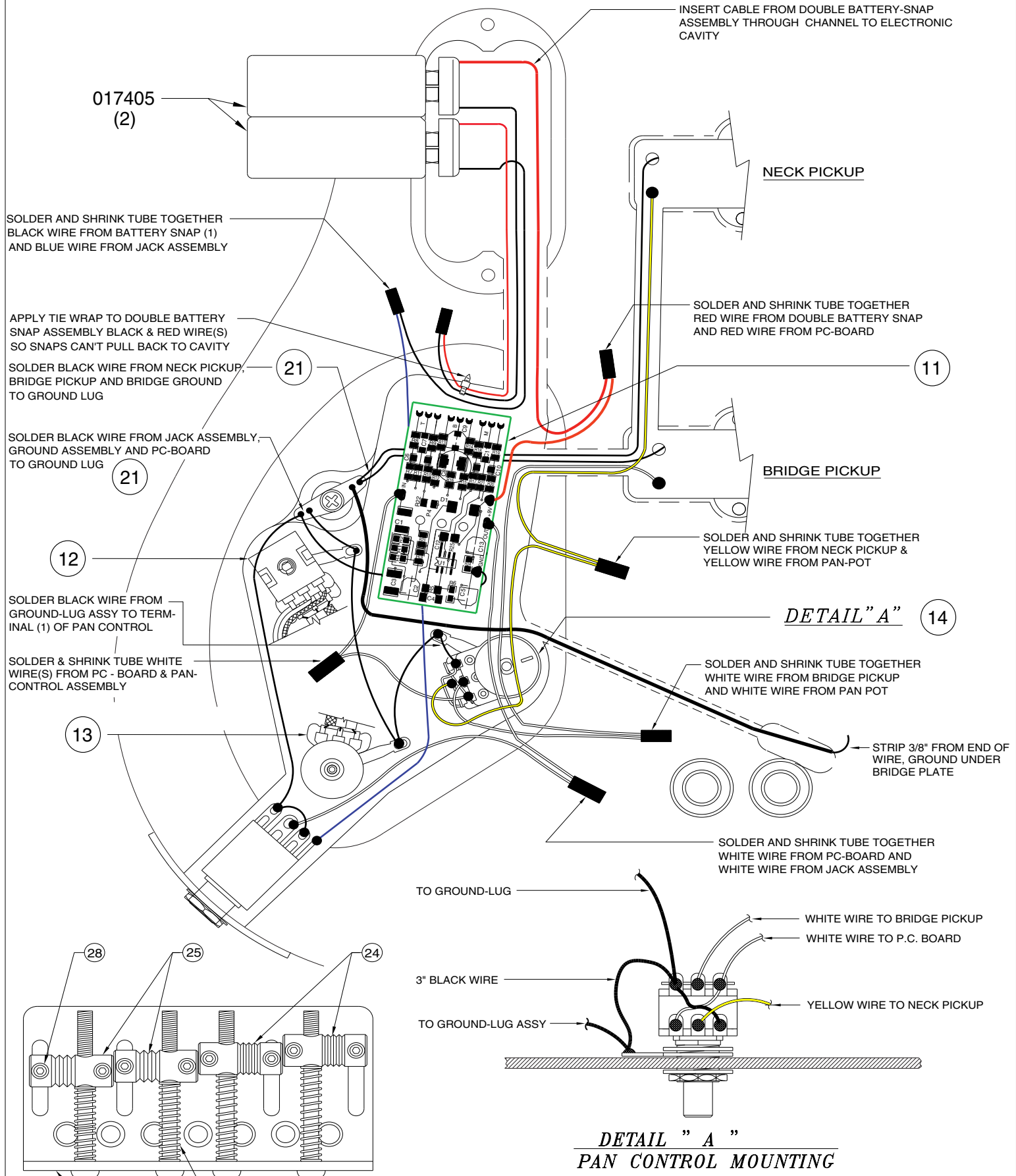

017405  
(2)

INSERT CABLE FROM DOUBLE BATTERY-SNAP ASSEMBLY THROUGH CHANNEL TO ELECTRONIC CAVITY

NECK PICKUP

SOLDER AND SHRINK TUBE TOGETHER BLACK WIRE FROM BATTERY SNAP (1) AND BLUE WIRE FROM JACK ASSEMBLY

SOLDER AND SHRINK TUBE TOGETHER RED WIRE FROM DOUBLE BATTERY SNAP AND RED WIRE FROM PC-BOARD

APPLY TIE WRAP TO DOUBLE BATTERY SNAP ASSEMBLY BLACK & RED WIRE(S) SO SNAPS CAN'T PULL BACK TO CAVITY

SOLDER BLACK WIRE FROM NECK PICKUP, BRIDGE PICKUP AND BRIDGE GROUND TO GROUND LUG

SOLDER BLACK WIRE FROM JACK ASSEMBLY, GROUND ASSEMBLY AND PC-BOARD TO GROUND LUG

SOLDER BLACK WIRE FROM GROUND-LUG ASSY TO TERMINAL (1) OF PAN CONTROL

SOLDER & SHRINK TUBE WHITE WIRE(S) FROM PC - BOARD & PAN-CONTROL ASSEMBLY

SOLDER AND SHRINK TUBE TOGETHER YELLOW WIRE FROM NECK PICKUP & YELLOW WIRE FROM PAN-POT

SOLDER AND SHRINK TUBE TOGETHER WHITE WIRE FROM BRIDGE PICKUP AND WHITE WIRE FROM PAN POT

STRIP 3/8" FROM END OF WIRE, GROUND UNDER BRIDGE PLATE

SOLDER AND SHRINK TUBE TOGETHER WHITE WIRE FROM PC-BOARD AND WHITE WIRE FROM JACK ASSEMBLY

TO GROUND-LUG

WHITE WIRE TO BRIDGE PICKUP  
WHITE WIRE TO P.C. BOARD

3" BLACK WIRE

YELLOW WIRE TO NECK PICKUP

TO GROUND-LUG ASSY

DETAIL " A " PAN CONTROL MOUNTING

BRIDGE ASSEMBLY